

## PARTS INCLUDED

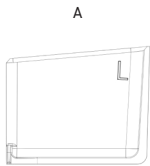

Left Insert  
(5)

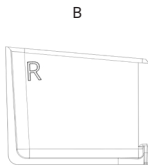

Right Insert  
(5)



Alcohol Prep Pad  
(1)



Dual Sided Adhesive  
(Extra 4)

## PREASSEMBLY

Using the included alcohol prep pad, wipe both the right and left inside mounting surfaces of the charging station. Ensure the charging bay is clean and dry before proceeding to the next steps.

Before removing the red film and permanently adhering the left and right insert, it is best to do a dry fit to ensure you are using the correct insert in the correct orientation.

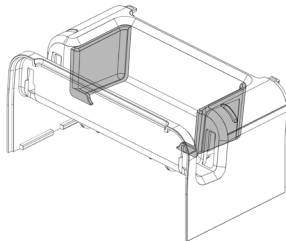
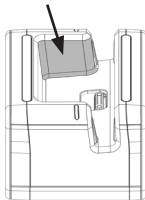
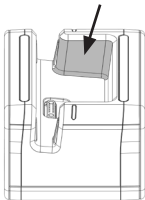

1. REMOVE THE RED FILM FROM THE RIGHT INSERT. ALIGN IT TO THE INSIDE RIGHT OF THE CHARGING BAY AND APPLY PRESSURE.

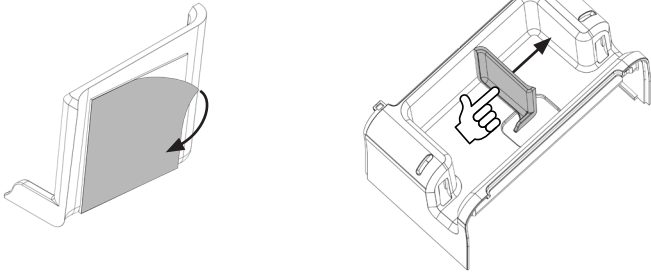

2. REMOVE THE RED FILM FROM THE LEFT INSERT. ALIGN IT TO THE INSIDE RIGHT OF THE CHARGING BAY AND APPLY PRESSURE.

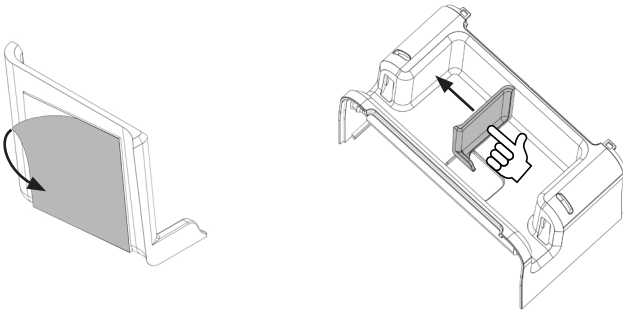

3. IF USING A MULTI BAY CHARGING STATION, REPEAT PREASSEMBLY AND STEPS 1 AND 2 FOR REMAINING BAYS.

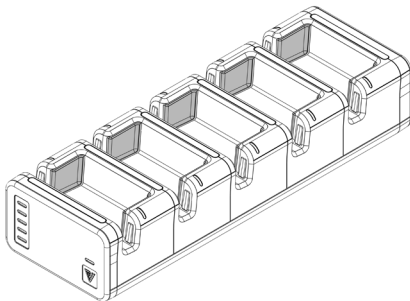

4. THE ADHESIVE WILL TAKE 24 HOURS TO FULLY ADHERE. PLEASE USE CAUTION WHEN DOCKING YOUR TABLETS BEFORE IT IS FULLY SET.

Assembly Complete